

assembly instructions

stainless steel sliding door fittings with flat supporting rod astec b.700

06.07.2015

step 1 make sure that all parts needed for installation have been supplied and are available. check whether skirting boards, light switches, door case or suchlike jut into the door area. the door leaf must slide freely. in addition to a drill, the only tools required are a cross-head screwdriver, 3 and 5 mm allen keys as well as the supplied special offset spanner wrench size 13.

step 2 wall mounting of the supporting rod

align supporting rod on wall surface and mark the drill holes. the door leaf should be approximately 5 - 8 mm from the floor. screw the tension screws just far enough into the wall plugs so that the recesses in the supporting rod can easily be fitted over the cylindrical retaining discs of the tension screws. the spacers to the left and right of the tension screws should not yet be in contact with the wall at this stage of installation. in the case of a movable stay, check whether it can still be slid on after mounting of the supporting rod. if necessary, slide into position on the supporting rod prior to mounting. once the supporting rod is mounted, tighten the tension screws using the supplied special offset spanner wrench size 13 so that the spacers sit tightly on the wall. prior to final tightening, make fine adjustments to ensure that the supporting rod is level.

step 2 2 fitting of the supporting rod for all-glass installations

first place the protective screw sleeves into the holes in the glass and then put the tension screws with the metric threads into these protective sleeves from the supporting rod side. make sure that the protective sleeves are flush on the supporting rod side. now secure the tension screws from the rear side of the glass using the stainless steel counter washers. make sure that the pvc protective washers are inserted.

tighten the tension screws just enough so that the recesses in the supporting rod can easily be fitted over the cylindrical retaining discs of the tension screws. the spacers to the left and right of the tension screws should not yet be in contact with the glass at this stage of installation. in the case of a movable stay, check whether it can still be slid on after mounting of the supporting rod. if necessary, slide into position on the supporting rod prior to mounting. once the supporting rod is fitted into place, tighten the tension screws using the supplied special offset spanner wrench size 13 so that the spacers sit tightly on the glass. make sure that the pvc washers are placed between glass and metal.

prior to final tightening, make fine adjustments to ensure that the supporting rod is level.

montageanleitung

stainless steel sliding door fittings with flat supporting rod astec b.700

06.07.2015

- step 3** fix runners to the door leaf. in the case of glass door leaves, it is essential to place pvc washers and pvc sleeves between the metal and glass. note: the visible cover disc on the front of the door leaf only has a decorative function. clamping of the door leaf is achieved via the central countersunk screw of the runner and the clamping disc with external thread.
- step 4** place the door with the runners on the supporting rod.
- step 5** fit anti-lift retainers (2nd runners) and fix tightly.
- step 6** fit adjustable clamp stays and adjust so that the position of the closed door is symmetrical to the door opening. when open, the flush pull or pull handle should be easily accessible to open and close the door.
- step 7** avoid drilling dust, use suction appliances. stainless steel surfaces are susceptible. work with care. once installation is completed, clean the surfaces with a stainless steel protective spray. please heed care instructions.

assembly instructions

example of dimensions
astec b.700

06.07.2015

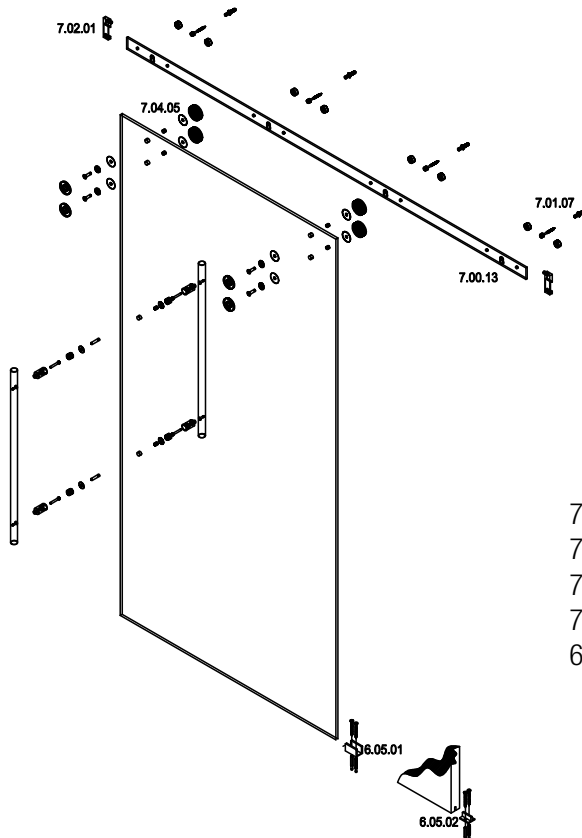
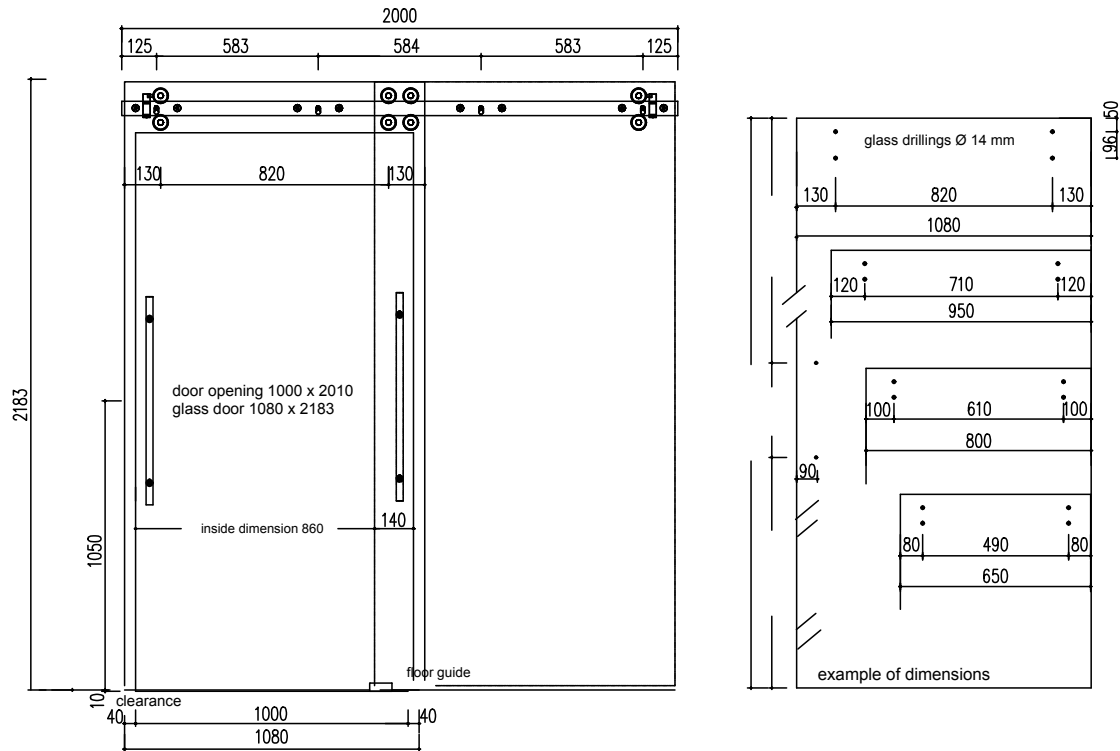

- 7.00.13 supporting bar 700
- 7.01.07 wall connection
- 7.02.01 end stop bilateral (left + right)
- 7.04.05 roller 700
- 6.05.01 floor guide

care and maintenance details

for stainless steel fittings

06.07.2015

design fittings made of stainless steel are made of rustproof stainless steel. the solid stainless steel V2A rustproof (material no. 1.4301) is precisely manufactured and of first class quality. especially the decorative surfaces are manufactured very extensively by grinding them and then finely brush them.

although stainless steel doesn't corrode under usual conditions in the atmosphere it is however essential to constantly maintain and care for the stainless steel products in order to maintain a nice and decorative surface as well as to ensure its hygienic features.

for regular care please use a usual stainless steel preservative spray . these sprays can be obtained from different manufacturers or can be bought in hardware stores or in specialized trade shops.

apply this cleaning agent with a soft cloth on the stainless steel surfaces and wipe off stain like oil, dirt or sweat etc. finish and polish with a dry cloth, then you can be sure to have a nice and good like stainless steel fitting for many years. please absolutely avoid any scratching, rubbing cleansers or tools.

as a matter of principle ball bearings of the rollers are sealed and life-long lubricated. wipe the polyamide rollers with a damp cloth. dust and other dirt from the air can cause coating at the rolls which results in unease running resp. blocking of the rolls. with roll fittings, the floor guides are to be cleaned regularly with a vacuum cleaner in order to clean particularly from rough dirt. small stones or other firm dirt are crashed by the runners or are pressed into the smooth polyamide or wood of the floor guide, both result in unease running or disturbing noise.

as a matter of principle, whenever runners don't run easily or cause noise, please check whether screws are fixed tight enough. please always use new tools for it, so that interior forms of screws do not get damaged, as they too, are a decorative part of the fittings. from time to time please also check whether fasteners are still tight enough and also if they are still at the correct position. likewise also the floor guide has to be checked whether it is still tight as well as the anti-lift out security.

your stainless steel fitting are grateful for being taken care of, and show this by long durability, good operation and an always nice and precious look.